

RYEFIELD ROAD, HEAPEY

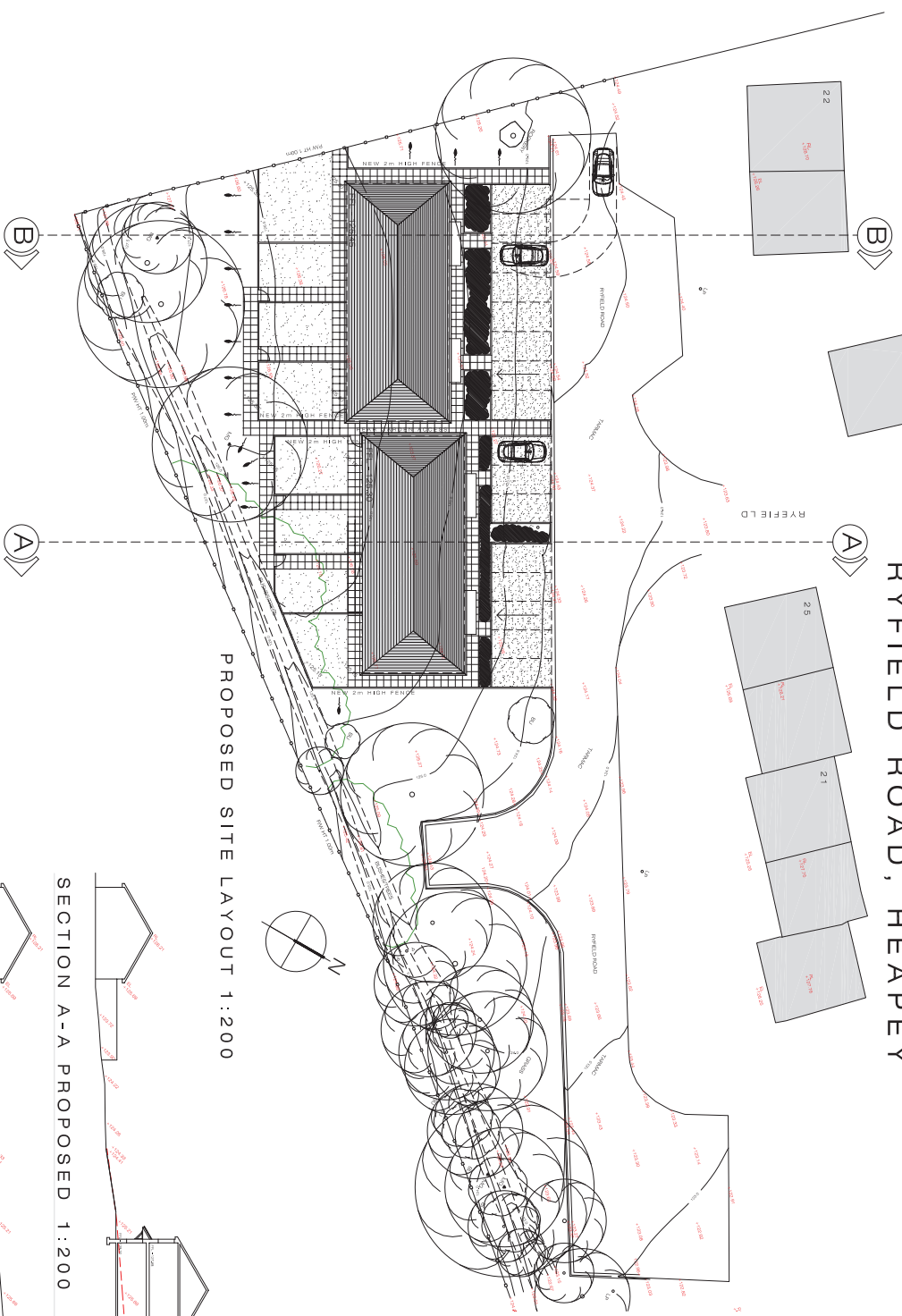

PROPOSED SITE LAYOUT 1:200

SECTION A-A PROPOSED 1:200

SECTION A-A EXISTING 1:200

SECTION B-B PROPOSED 1:200

SECTION B-B EXISTING 1:200

1. The client and I have agreed to work together and I will provide the client with the best possible design and construction solution. I will provide the client with the best possible design and construction solution. I will provide the client with the best possible design and construction solution.

eastern tickler (revised) (m south)	1:100/1:3 A
roadline	1:100
existing	1:100
proposed	1:100
ryefield road	1:100
heapey road	1:100



architectural
consultancy
41 FIVE
151 772 3278/9
031 772 3278/8
THE WILLOWS, 608 LANE,
PENNYCORNERS, HEAPEY, PN1 5DU

project no. 1305
stage no. 03
rev. A